

THIS DRAWING IS UNPUBLISHED. RELEASED FOR PUBLICATION, 19 .
 © COPYRIGHT 19 BY AMP INCORPORATED. ALL INTERNATIONAL RIGHTS RESERVED.

LOC	DIST	P	F	ZONE	LTR	REVISIONS	DATE	APPD
AF	50				K	REVISD STATUS PER 0G3A-0519-01	18SEP01	MF-DD

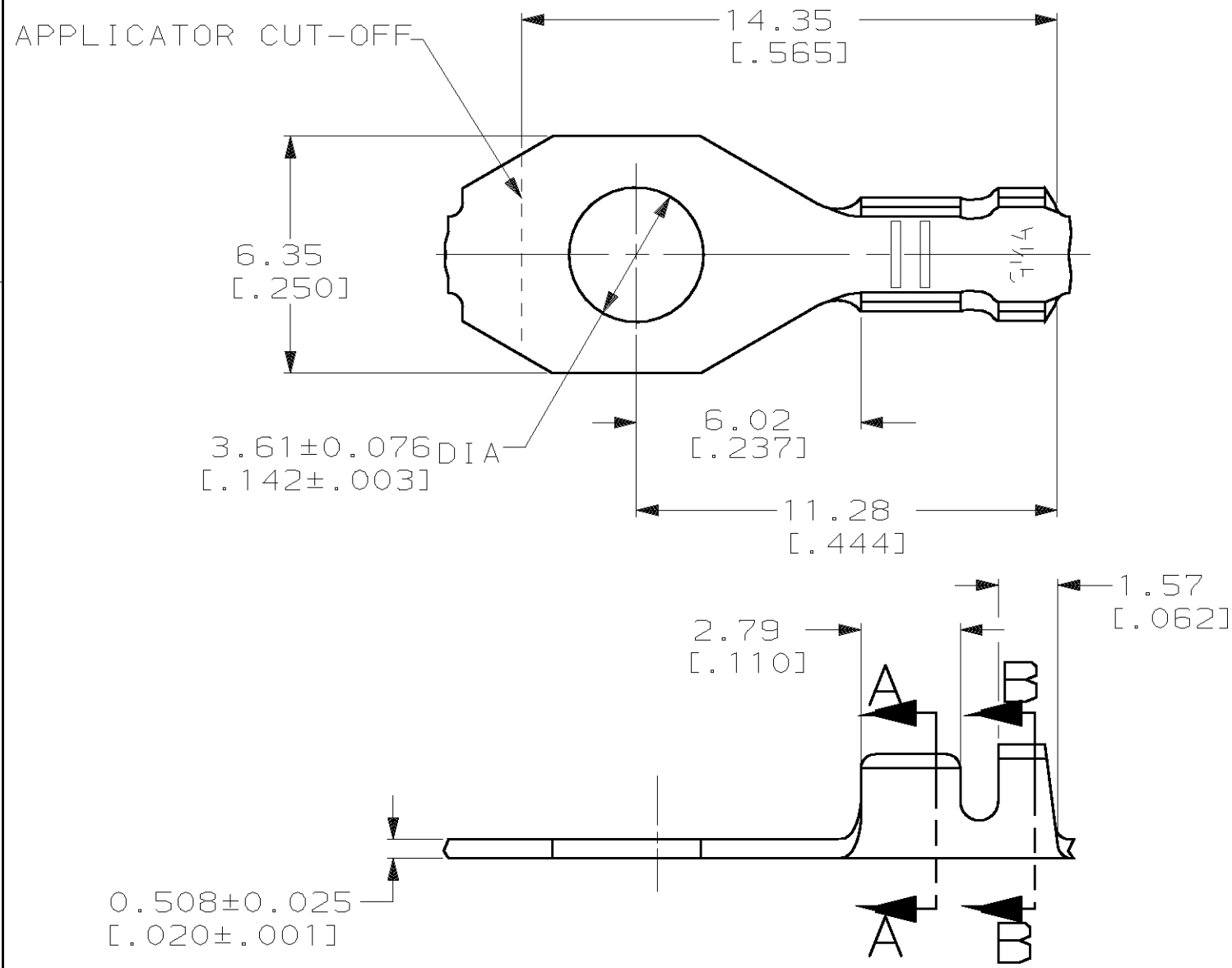

1 CONTINUOUS STRIP ON REELS
 2 8000 PER REEL.

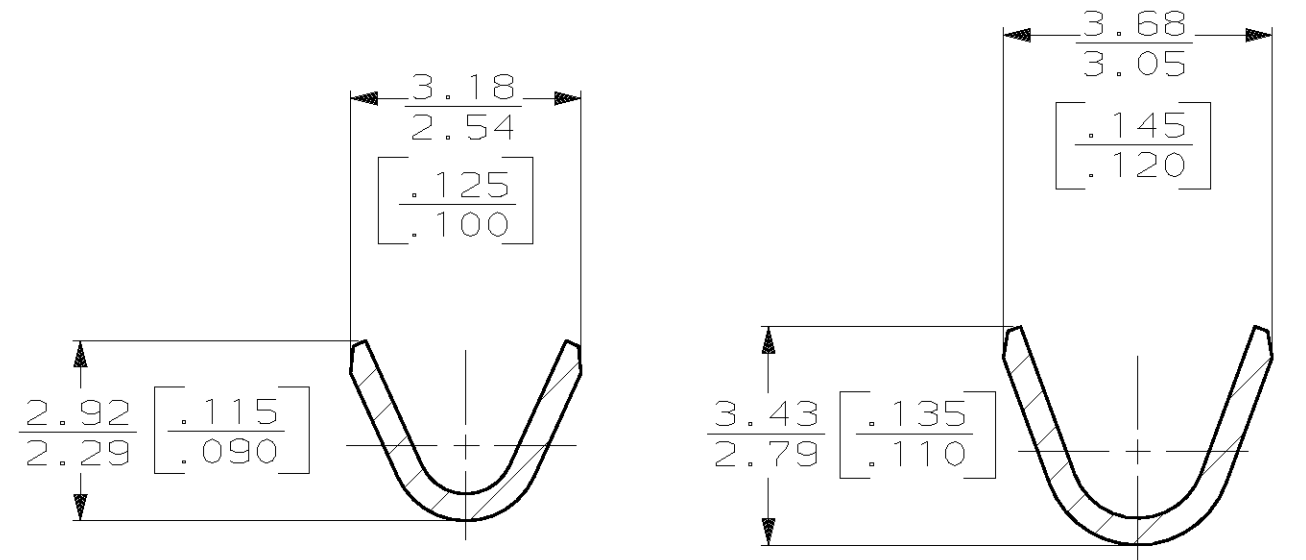

SECTION A-A
SCALE 10:1

SECTION B-B
SCALE 10:1

METRIC

F OR 0	2.79 [.110]	4.06 [.160]	F	2.03 [.080]	1.40 [.055]	0.5mm ² [20]
TYPE	WIDTH	STRIP LENGTH ±0.38 [±.015]	TYPE	WIDTH	HEIGHT	WIRE
INSUL BARREL CRIMP			WIRE BARREL CRIMP			

0.002032 [.000080] MIN TIN PL PER MIL-T-10727	1.22-1.98 [.048-.078] DIA	0.13mm ² -0.5mm ² [26-20] AWG	60123-3 2
0.002032 [.000080] MIN TIN PL PER MIL-T-10727	1.22-1.98 [.048-.078] DIA	0.13mm ² -0.5mm ² [26-20] AWG	60123-2

FINISH	INSULATION RANGE	WIRE RANGE	PART NO
#2 HARD BRASS			
FINISH	SEE TABLE		
DR 4/5/90 P FORTNEY	CHK 4/5/90 JR RUTH	APPD 4/5/90 G YETTER	APPD 4/5/90 R KUZO
<p>AMP AMP Incorporated Harrisburg, PA 17105-3608</p> <p>NAME: RING</p>			
SIZE	CAGE CODE	DRAWING NO	
B	00779	60123	
SCALE	6:1	SHEET	1 OF 1